

SCALE SPRING SUPPORT **NEWALL**

Installation Guide

This support is for applications where the reader head is the moving member, and the scale tube is stationary

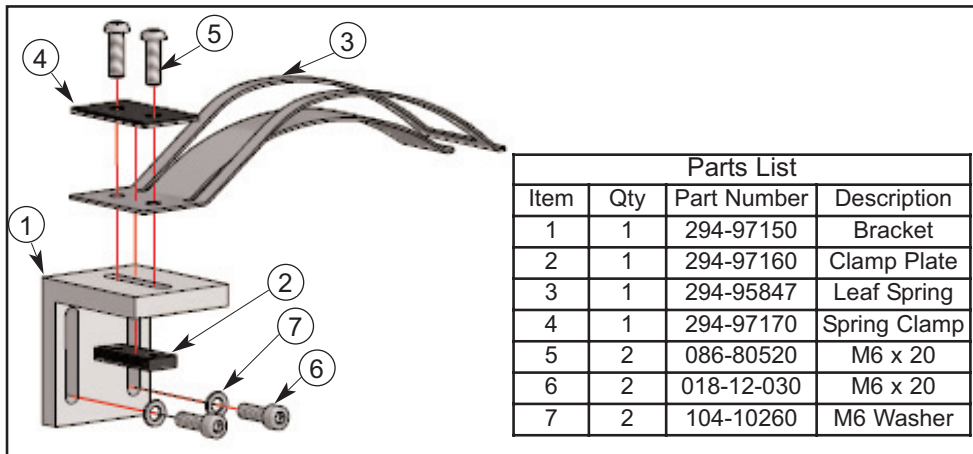
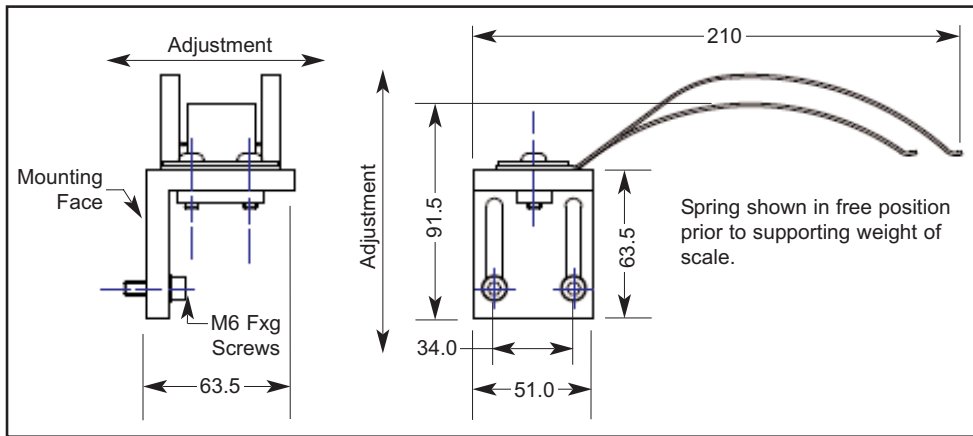

HEAD OFFICE

Newall Measurement Systems Ltd.
 Technology Gateway, Cornwall Road
 South Wigston
 Leicester LE18 4XH
 United Kingdom
 Telephone: +44 (0)116 264 2730
 Facsimile: +44 (0)116 264 2731
 Email: sales@newall.co.uk
 Web: http://newall.com

Newall Electronics, Inc.

1778 Dividend Drive
 Columbus, OH 43228
 Telephone: +1 614 771 0213
 Toll Free: 800.229.4376
 Facsimile: +1 614 771 0219
 Email: sales@newall.com
 Web: http://newall.com

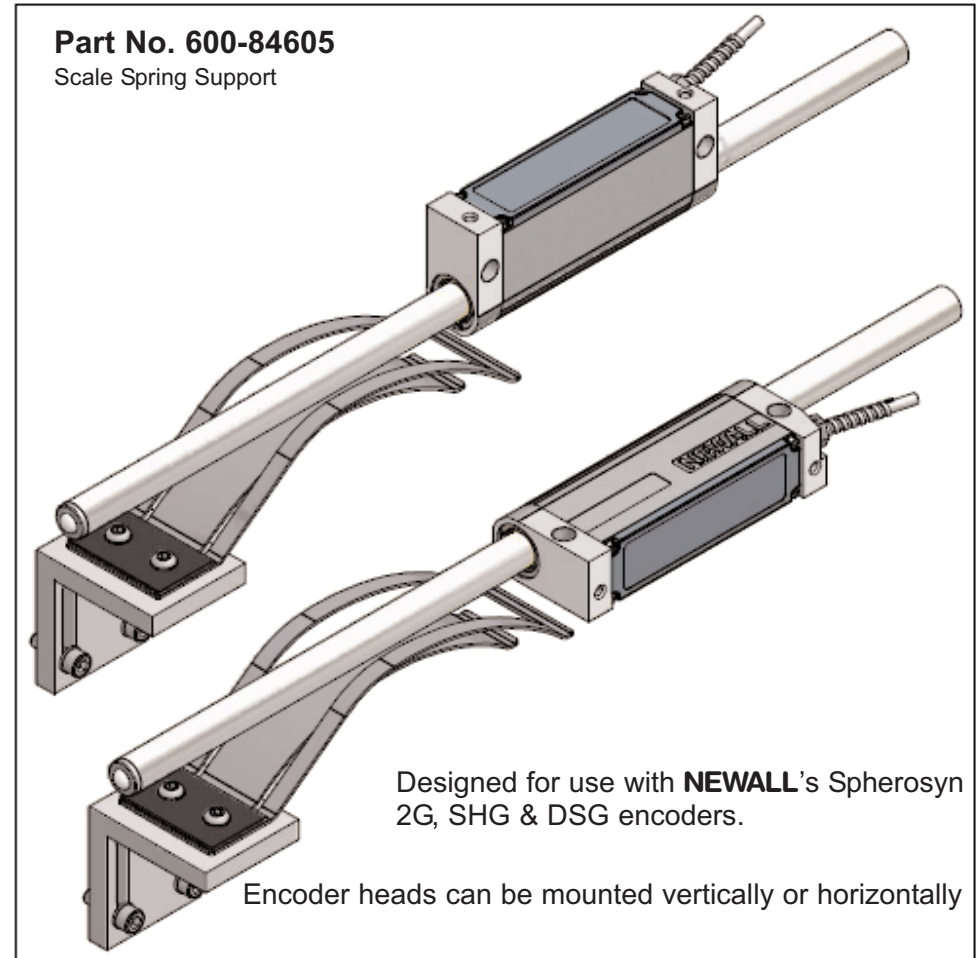

A brand of
CST
 CUSTOM SPINDLES & TECHNIQUE
 023-81460/0

A full hard copy of the manual is available free of charge on request

PROCEDURE

STEP 1

± 0.005mm (0.002")

Long scale mount and clamp

Encoder head can be installed vertically or horizontally

Install and align reader head and scale end brackets as described in the installation manual

STEP 2

Brackets

Install 600-84605 spring support assemblies.
 Supports should be positioned along the length of the scale and spaced in increments of $X=1.5\text{m}$ max.
 Between 2.5 & 3.0m scale overall lengths use 1 off support.
 Between 3.0 & 4.5m scale overall lengths use 2 off supports.
 For longer lengths use an additional support for every 1.5m added.

STEP 3

Move head close to 600-84605 support.
 Adjust height so that it is slightly higher than the top of the scale tube hole in the head.

STEP 4

Equal clearance each side

Insert scale tube.
 Move head close to support.

Use a gauge to set scale tube destination height.

STEP 5

Move head past and close to the next support.

STEP 6

Spring support assembly is bearing weight of scale tube.
 Adjust spring support vertically until scale tube touches gauge.

Repeat steps 3-6 for all remaining supports

Notes:

Correct assembly and height setting of the supports is essential to eliminate the possibility of scales becoming bent, inaccurate measurements and potential wear to encoder head and supports.

See rear page for dimensional details and component parts.